



## Gymnasium Equipment Specification

### **RS 119 U Side Fold Basketball Backstop**

#### SUPPLY & INSTALL:

RS 119 U Backstop, as supplied by Royal Stewart Ltd.

Frame shall be made of 2" (51 mm) square tubing and mounted to the wall by means of ¼" x 4" (6 mm x 102 mm) steel plates 63" (1600 mm) on center.

Stabilizing bars shall be made using 2" (51 mm) tubing and run from the front of the backstop frame up to the wall in a 30-degree angle.

Stabilizers shall be hinge mounted to allow for minor adjustment. Cable bracing shall not be permitted.

Backstop shall have a built-in spring-loaded locking bar. Release handle shall be supplied.

Backstop shall be painted flat black.

Wall bolts shall be supplied as indicated on the shop drawing for installation by others.

This backstop is specifically designed for glass rectangular backboards.

All other accessories to be supplied as specified.

- MODEL -	- A -	- B -
RS-119U	4'-0" (48")	13'-7 1/2" (163 1/2")
	4'-6" (54")	13'-10 1/4" (166 1/4")
	5'-0" (60")	14'-1" (169")
	5'-6" (66")	14'-3 3/4" (171 3/4")
	6'-0" (72")	14'-6 1/2" (174 1/2")
	6'-6" (78")	14'-9 1/2" (177 1/2")
	7'-0" (84")	15'-0 1/4" (180 1/4")
	7'-6" (90")	15'-3" (183")
	8'-0" (96")	15'-5 3/4" (185 3/4")
	8'-6" (102")	15'-8 1/2" (188 1/2")
	9'-0" (108")	15'-11 1/4" (191 1/4")
	9'-6" (114")	16'-2" (194")
	10'-0" (120")	16'-4 3/4" (196 3/4")
	10'-6" (126")	16'-7 5/8" (199 5/8")
	11'-0" (132")	16'-8 1/4" (200 1/4")
	11'-6" (138")	
	12'-0" (144")	
12'-6" (150")		
13'-0" (156")		
13'-6" (162")		
14'-0" (168")		

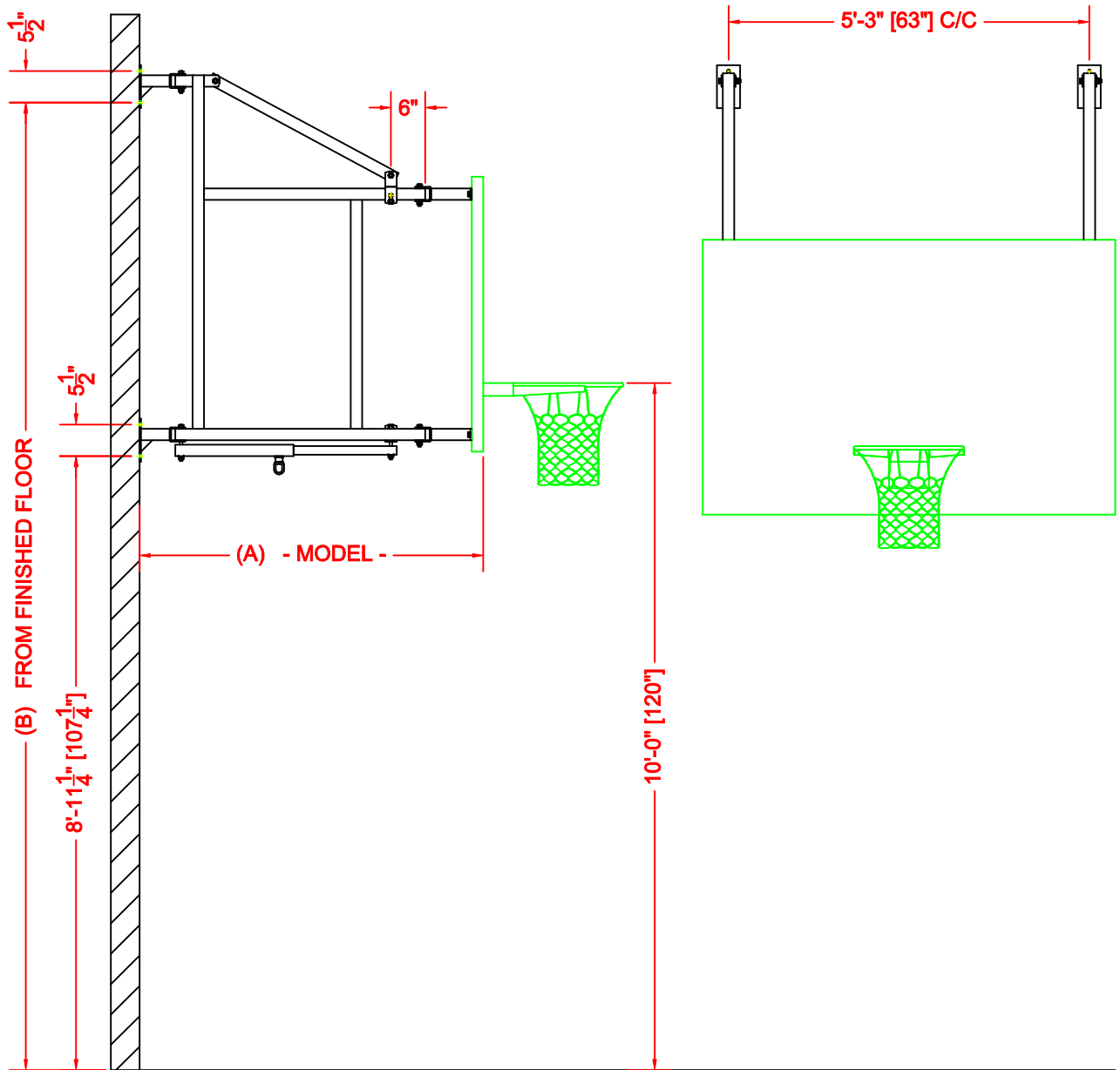
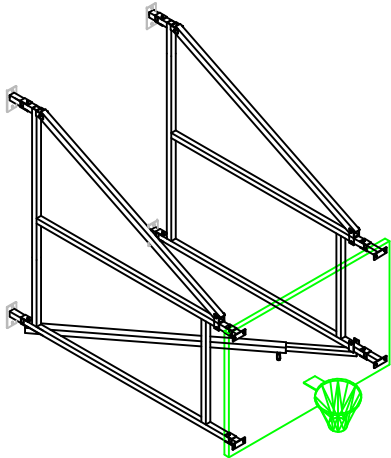

WORK ORDER / TRACKING NO		QTY REQUIRED		<b>ROYAL STEWART LTD.</b> Your Sports Facility and Auditorium Specialists 240 I-XL Cres. (St. Clements Ind. Park) Lockport, Manitoba, Canada, R1A 3R9		1
MATERIAL FRAME : 2" x 2" SQ. TUBING						1
TITLE RS-119U - SIDEFOLD BACKSTOP				SCALE N.T.S.	DWG SHEET NO 1	ROUTING
				DRAWN BY ET	DWG NO	REV A
				DATE 04/30/04		

A	04/30/04	DRAWING RELEASE	ET
REV	DATE	REVISIONS DESCRIPTION	BY CHK'D
DO NOT SCALE DWG. UOS DIMENSIONS ARE IMPERIAL INCHES			